



NASSAU COUNTY INDUSTRIAL
DEVELOPMENT AGENCY

APPLICATION FOR FINANCIAL ASSISTANCE

APPLICATION OF:

400 WJS LLC

APPLICANT NAME

Please respond to all questions in this Application for Financial Assistance (the "Application") by, as appropriate:

- filling in blanks;
- checking the applicable term(s);
- attaching additional text (with notation in Application such as "see Schedule H, Item # 1", etc.); or
- writing "N.A.", signifying "not applicable".

All attachments responsive to questions found in this Application should be clearly labeled and attached as Schedule I to the Application. If an estimate is given, enter "EST" after the figure. One signed original and one photocopy of the Application (including all attachments) must be submitted.

The following amounts are payable to the Nassau County Industrial Development Agency (the "Agency") at the time this Application is submitted to the Agency: (i) a \$1,000 non-refundable application fee (the "Application Fee"); (ii) a \$3,500 expense deposit for the Agency's Transaction/Bond Counsel fees and expenses (the "Counsel Fee Deposit"), (iii) a \$2,500 expense deposit for the cost/benefit analysis with respect to the project contemplated by this Application (the "Cost/Benefit Deposit"), and (iv) a \$500 expense deposit for the real property tax valuation analysis, if applicable, with respect to the project contemplated by this Application (the "Valuation Deposit"). The Application Fee will not be credited against any other fees or expenses which are or become payable to the Agency in connection with this Application or the project contemplated herein (the "Project"). In the event that the subject transaction does not close for any reason, the Agency may use all or any part of the Counsel Fee Deposit, the Cost/Benefit Deposit and/or the Valuation Deposit to defray the cost of Transaction/Bond Counsel fees and expenses, the cost of obtaining a cost/benefit analysis and/or the cost of obtaining a real property tax valuation with respect to the Project. In the event that the subject transaction does close, the Counsel Fee Deposit, the Cost/Benefit Deposit and the Valuation Deposit shall be credited against the applicable expenses incurred by the Agency with respect to the Project.

Every signature page comprising part of this Application must be signed by the Applicant or this Application will not be considered complete or accepted for consideration by the Agency.

The Agency's acceptance of this Application for consideration does not constitute a commitment on the part of the Agency to undertake the proposed Project, to grant any financial assistance with respect to the proposed Project or to enter into any negotiations with respect to the proposed Project.

Information provided herein may be subject to disclosure under the New York Freedom of Information Law (New York Public Officers Law § 84 et seq.) ("FOIL"). If the Applicant believes that a portion of the material submitted with this Application is protected from disclosure under FOIL, the Applicant should mark the applicable section(s) or page(s) as "confidential" and state the applicable exception to disclosure under FOIL.

September 11, 2018

DATE

PART I. APPLICANT

A. APPLICANT FOR FINANCIAL ASSISTANCE:

Name: 400 WJS LLC

Address: 301 North Broadway, Jericho, NY 11753

Fax: _____

NY State Dept. of
Labor Reg #: N/A Federal Employer ID # _____

NAICS Code #: 531190

Website: _____

Name of CEO or
Authorized Representative Certifying Application: Arthur D. Sanders

Title of Officer: Manager

Phone Number: (516) 922-3838 E-Mail: ads@sandersecurities.com

B. BUSINESS TYPE (Check applicable status. Complete blanks as necessary):

Sole Proprietorship ___ General Partnership ___ Limited Partnership ___

Limited Liability Company X Privately Held Corporation ___

Publicly Held Corporation ___ Exchange listed on _____

Not-for-Profit Corporation ___

Income taxed as: Subchapter S ___ Subchapter C ___
501(c)(3) Corporation ___ Partnership X

State and Year of Incorporation/Organization: New York, 2015

Qualified to do Business in New York: Yes X No ___ N/A ___

C. APPLICANT COUNSEL:

Firm name: Forchelli Deegan Terrana LLP

Address: 333 Earle Ovington Blvd., Suite 1010, Uniondale, NY 11553

Primary _____
Contact: Daniel P. Deegan, Esq.
Phone: (516) 248-1700
Fax: (516) 248-1729
E-Mail: DDeegan@forchellilaw.com

- D. Principal stockholders, members or partners, if any (i.e., owners of 10% or more of equity/voting rights in Applicant):

Name	Percentage owned
<u>Arthur D. Sanders</u>	<u>31.02 %</u>
<u>Jordan Avi Sanders (2015 GST Trust)</u>	<u>29.66 %</u>
<u>Erin Leigh Sanders (2015 GST Trust)</u>	<u>19.66 %</u>
<u>Remy Blayne Sanders (2015 GST Trust)</u>	<u>19.66 %</u>

- E. If any of the persons described in the response to the preceding Question, or a group of said persons, owns more than a 50% interest in the Applicant, list all other entities which are related to the Applicant by virtue of such persons having more than a 50% interest in such entities:

N/A

F. Is the Applicant related to any other entity by reason of more than 50% common ownership? If YES, indicate name of related entity and relationship:

YES

NO

G. List parent corporation, sister corporations and subsidiaries, if any:

N/A

H. Has the Applicant (or any parent company, subsidiary, affiliate or related entity or person) been involved in, applied for or benefited by any prior industrial development financing in the municipality in which this Project is located, whether by the Agency or another issuer, or in a contiguous municipality? ("Municipality" herein means city, town or village, or, if the Project is not in an incorporated city or village, Nassau County.) If YES, describe:

YES

NO

I. Is the Applicant (or any parent company, subsidiary, affiliate or related entity or person) or any principal(s) of the Applicant or its related entities involved in any litigation or aware of any threatened litigation that would have a material adverse effect on the Applicant's financial condition or the financial condition of said principal(s)? If YES, attach details at Schedule I.

YES

NO

J. Has the Applicant (or any parent company, subsidiary, affiliate or related entity or person) or any principal(s) of the Applicant or its related entities, or any other business or concern with which such entities, persons or principal(s) have been connected, ever been involved, as debtor, in bankruptcy, creditors rights or receivership proceedings or sought protection from creditors? If YES, attach details at Schedule I.

YES

NO

K. Has the Applicant (or any parent company, subsidiary, affiliate or related entity or person) or any principal(s) of the Applicant or its related entities, ever been convicted of any felony or misdemeanor (other than minor traffic offenses), or have any such related persons or principal(s) held positions or ownership interests in any firm or corporation that has been convicted of a felony or misdemeanor (other than minor traffic offenses), or are any of the foregoing the subject of a pending criminal proceeding or investigation? If YES, attach details at Schedule I.

YES ___ NO X

L. Has the Applicant (or any parent company, subsidiary, affiliate or related entity or person) or any principal(s) of the Applicant or its related entities, or any other business or concern with which such entities, persons or principal(s) have been connected, been cited for (or is there a pending proceeding or investigation with respect to) a civil violation of federal, state or local laws or regulations with respect to labor practices, hazardous wastes, environmental pollution, taxation, or other operating practices? If YES, attach details at Schedule I.

YES ___ NO X

M. Is the Applicant (or any parent company, subsidiary, affiliate or related entity or person) or any principal(s) of the Applicant or its related entities, or any other business or concern with which such entities, persons or principal(s) have been connected, delinquent or have any of the foregoing persons or entities been delinquent on any New York State, federal or local tax obligations within the past five (5) years? If YES, attach details at Schedule I.

YES ___ NO X

N. Complete the following information for principals (including, in the case of corporations, officers and members of the board of directors and, in the case of limited liability company, members and managers) of the Applicant:

<u>Name</u>	<u>Title</u>	<u>Other Business Affiliations</u>
Arthur D. Sanders	Member	_____
Jordan Avi Sanders	Member	_____
Erin Leigh Sanders	Member	_____
Remy Blayne Sanders	Member	_____

Do any of the foregoing principals hold elected or appointive positions with New York State, any political division of New York State or any other governmental agency? If YES, attach details at Schedule I.

YES ___ NO X

Are any of the foregoing principals employed by any federal, state or local municipality or any agency, authority, department, board, or commission thereof or any other governmental or quasi-governmental organization?

YES ___ NO X

O. Operation at existing location(s) (Complete separate Section O for each existing location):

1. (a) Location: New location

(b) Number of Employees: Full-Time: ___ Part-Time: ___

(c) Annual Payroll, excluding benefits: N/A

(d) Type of operation (e.g. manufacturing, wholesale, distribution, retail, etc.) and products or services: N/A

(e) Size of existing facility real property (i.e., acreage of land): N/A

(f) Buildings (number and square footage of each): N/A

(g) Applicant's interest in the facility

FEE TITLE: X LEASE: ___ OTHER (describe below): ___

2. Will the completion of the proposed Project result in the removal of a plant or facility of the Applicant, or of a proposed user, occupant or tenant of the Project, or a relocation of any employee of the Applicant, or any employee of a proposed user, occupant or tenant of the Project, from one area of the State of New York (but outside of Nassau County) to a location in Nassau County or in the abandonment of such a plant or facility located in an area of the State of New York outside of Nassau County? If YES, complete the attached Anti-Raiding Questionnaire (Schedule D).

YES ___ NO X

3. Will the proposed Project result in the removal or abandonment of a plant or facility of the Applicant, or of a proposed user, occupant or tenant of the proposed Project, or a relocation of any employee of the Applicant, or any employee of a proposed user, occupant or tenant of the proposed Project, located within Nassau

County? If YES, identify the location of the plant or facility and provide explanation.

YES ___

NO X

P. Has the Applicant considered moving to another state or another location within New York State? If YES, explain circumstances.

YES ___

NO X

Q. Does any one supplier or customer account for over 50% of Applicant's annual purchases or sales, respectively? If YES, attach name and contact information for supplier and/or customer, as applicable:

YES ___

NO X

R. Does the Applicant (including any related entity or person) or any principal(s) of the Applicant or its related entities, or any other business or concern with which such entities, persons or principal(s) have been connected, have any contractual or other relationship with the Agency or the County of Nassau? If YES, attach details at Schedule I.

YES ___

NO X

S. Nature of Applicant's business (e.g., description of goods to be sold, products manufactured, assembled or processed, services rendered):

Real estate holding company.

T. ANY RELATED PARTY PROPOSED TO BE A USER OF THE PROJECT:

Name: To be determined

Relationship to Applicant: _____

Provide the information requested in Questions A through S above with respect to each such party by attachment at Schedule I.

PART II. PROPOSED PROJECT

A. Types of Financial Assistance Requested:

- Tax-Exempt Bonds
- Taxable Bonds
- Refunding Bonds
- Sales/Use Tax Exemption
- Mortgage Recording Tax Exemption
- Real Property Tax Exemption
- Other (specify): _____

B. Type of Proposed Project (check all that apply and provide requested information):

- New Construction of a Facility
Square footage: 42,454 sq. ft.
- Addition to Existing Facility
Square footage of existing facility: _____
Square footage of addition: _____
- Renovation of Existing Facility
Square footage of area renovated: _____
Square footage of existing facility: _____
- Acquisition of Land/Building
Acreage/square footage of land: _____
Square footage of building: _____
- Acquisition of Furniture/Machinery/Equipment
List principal items or categories:
Building systems, construction equipment, I.T. equipment, FF&E for industrial building.

- Other (specify): _____

C. Briefly describe the purpose of the proposed Project, the reasons why the Project is necessary to the Applicant and why the Agency's financial assistance is necessary, and the effect the Project will have on the Applicant's business or operations:

The Applicant is proposing to construct a 42,545 sq. ft. warehouse with ceiling heights ranging from 30 to 33 feet. The proposed project is situated in an area where warehouse space with substantial ceiling

height is in high demand. Without the financial assistance of the Agency, the real estate taxes would make the financial viability of the Project unsustainable.

- D. Is there a likelihood that the proposed Project would not be undertaken by the Applicant but for the granting of the financial assistance by the Agency? (If yes, explain; if no, explain why the Agency should grant the financial assistance with respect to the proposed Project)

YES X NO

If the Agency does not award financial assistance, the Project would not be financially feasible and the Applicant would not proceed with the Project.

- E. If the Applicant is unable to arrange Agency financing or other Agency financial assistance for the Project, what will be the impact on the Applicant and Nassau County? Would the Applicant proceed with the Project without Agency financing or other Agency financial assistance? Describe.

If the Applicant is not awarded financial assistance for the Project, the Applicant will be forced to abandon the Project. As a result, the County would lose the future jobs and much needed warehouse space this Project will bring to the community.

- F. Location of Project:

Street Address: 400 West John Street and 3-9 Kuhl Avenue, Hicksville

City/Village(s): _____

Town(s): Town of Oyster Bay

School District(s): Hicksville

Tax Map Section: 11 Block: 499 Lot: 90 & 102

Census Tract Number: _____

- G. Present use of the Project site: Vacant 8,423 sq. ft. warehouse/office building (recently demolished at the expense of the Applicant)

H. (a) What are the current real estate taxes on the Project site? (If amount of current taxes is not available, provide assessed value for each):

General: \$71,678.52
School: \$69,623.91
Village: \$ _____

(b) Are tax certiorari proceedings currently pending with respect to the Project real property? If YES, attach details at Schedule I including copies of pleadings, decisions, etc.

YES X NO

I. Describe proposed Project site ownership structure (*i.e.*, Applicant or other entity):

The property is currently owned by the Applicant and is intended to be leased to a party to be determined.

J. To what purpose will the building or buildings to be acquired, constructed or renovated be used by the Applicant? (Include description of goods to be sold, products to be manufactured, assembled or processed and services to be rendered.)

A new one-story warehouse/office facility is to be constructed and the Applicant intends to enter into a lease agreement with a future tenant.

K. If any space in the Project is to be leased to or occupied by third parties (*i.e.*, parties not related to the Applicant), or is currently leased to or occupied by third parties who will remain as tenants, provide the names and contact information for each such tenant, indicate total square footage of the Project to be leased to each tenant, and describe proposed use by each tenant:

Future tenant to be determined.

L. Provide, to the extent available, the information requested, in Part I, Questions A, B, D and O, with respect to any party described in the preceding response.

N/A

M. Does the proposed Project meet zoning/land use requirements at proposed location?

YES

NO

1. Describe present zoning/land use: Light Industry/Neighborhood Business

2. Describe required zoning/land use, if different: N/A

3. If a change in zoning/land use is required, please provide details/status of any request for change of zoning/land use requirements:

N/A

N. Does the Applicant, or any related entity or person, currently hold a lease or license on the Project site? If YES, please provide details and a copy of the lease/license.

YES

NO

O. Does the Applicant, or any related entity or person, currently hold fee title to (i.e. own) the Project site?

YES

NO

If YES, indicate:

(a) Date of purchase: December 30, 2014

(b) Purchase price: \$1,625,000

(c) Balance of existing mortgage, if any: \$ N/A

(d) Name of mortgage holder: N/A

(e) Special conditions: N/A

If NO, indicate name of present owner of Project site: _____

P. Does the Applicant or any related person or entity have an option or a contract to purchase the Project site and/or any buildings on the Project site?

YES

NO

If YES, attach copy of contract or option at Schedule I and indicate:

¹ **At the request of the neighbors to the north of the Subject Property, the Applicant is applying for a fence height variance.

- (a) Date signed: _____
- (b) Purchase price: \$ _____
- (c) Closing date: _____

Is there a relationship legally or by virtue of common control or ownership between the Applicant (and/or its principals) and the seller of the Project (and/or its principals)?
If YES, describe:

YES _____ NO X _____

Q. Will customers personally visit the Project site for either of the following economic activities? If YES with respect to either economic activity indicated below, complete the attached Retail Questionnaire (Schedule E).

Sales of Goods: YES _____ NO X _____ Sales of Services: YES _____ NO X _____

R. Describe the social and economic conditions in the community where the Project site is or will be located and the impact of the proposed Project on the community (including impact on infrastructure, transportation, fire and police and other government-provided services):

The surrounding neighborhood is developed with neighborhood business/industrial properties to the south, along West John Street; single-family residential housing to the east and northeast of the Project; a stormwater recharge basin to the west; and a public golf course – part of Nassau County Cantiague Park – located to the north.

S. Identify the following Project parties (if applicable):

Architect: Ted Pupilla
 Engineer: Charles F. Panetta, L.P.E., L.L.S.
 Contractors: TBD

T. Will the Project be designed and constructed to comply with Green Building Standards? (if YES, describe the LEED green building rating that will be achieved):

YES _____ NO X _____

U. Is the proposed Project site located on a Brownfield? (if YES, provide description of contamination and proposed remediation)

YES ___ NO X

V. Will the proposed Project produce a unique service or product or provide a service that is not otherwise available in the community in which the proposed Project site is located?

YES X NO ___

The proposed Project offers warehouse ceiling clearance of 30-33 feet in height which is not available in surrounding properties with similar uses.

W. Is the proposed Project site currently subject to an IDA transaction (whether through the Agency or otherwise)? If yes, explain.

YES ___ NO X

PART III. CAPITAL COSTS OF THE PROJECT

A. Provide an estimate of cost of all items listed below:

	<u>Item</u>	<u>Cost</u>
1.	Land and/or Building Acquisition	\$1,625,000.00
2.	Building Demolition	\$N/A
3.	Construction/Reconstruction/Renovation	\$2,872,520.00
4.	Site Work	\$1,821,000.00
5.	Infrastructure Work	\$
6.	Architectural/Engineering Fees	\$
7.	Applicant's Legal Fees	\$
8.	Financial Fees	\$
9.	Other Professional Fees	\$
10.	Furniture, Equipment & Machinery	\$

	Acquisition (not included in 3. above)	
11.	Other Soft Costs (describe)	\$234,676.00 (Contingency fee 5%)
12.	Other (describe)	\$739,229.40 (Management fee 15%)
	Total	\$7,292,425.40

B. Estimated Sources of Funds for Project Costs:

a.	Tax-Exempt IDA Bonds:	\$ _____
b.	Taxable IDA Bonds:	\$ _____
c.	Conventional Mortgage Loans:	\$ _____
d.	SBA or other Governmental Financing: Identify: _____	\$ _____
e.	Other Public Sources (e.g., grants, tax credits): Identify: _____	\$ _____
f.	Other Loans:	\$ _____
g.	Equity Investment: (excluding equity attributable to grants/tax credits)	\$7,292,425.40
	TOTAL	\$7,292,425.40

What percentage of the total project costs are funded/financed from public sector sources: 0 %

C. Have any of the above costs been paid or incurred (including contracts of sale or purchase orders) as of the date of this application? If YES, describe particulars on a separate sheet. **See attached Schedule I.**

YES X NO _____

D. Are items of working capital, moving expenses, work in progress, or stock in trade included in the proposed uses of the bond proceeds (if applicable)? If YES, provide details:

YES _____ NO _____ NOT APPLICABLE X

E. Will any of the funds to be borrowed through the Agency's issuance of bonds, if applicable, be used to repay or refinance an existing mortgage, outstanding loan or an outstanding bond issue? If YES, provide details:

YES NO NOT APPLICABLE

F. Has the Applicant made any arrangement for the marketing or the purchase of the bonds or the provision of other third party financing (if applicable)? If YES, indicate with whom (subject to Agency approval) and provide a copy of any term sheet or commitment letter issued with respect to such financing.

YES NO NOT APPLICABLE

- G. Construction Cost Breakdown:
- Total Cost of Construction: \$4,693,520 (sum of 2-5 and 10 in Question A above)
- Cost for materials: \$2,422,696
- % Sourced in County: TBD %
- % Sourced in State: TBD % (incl. County)
- Cost for labor: \$2,013,944
- % Sourced in County: 75 %
- % Sourced in State: 100 % (incl. County)
- Cost for "other": \$256,880
- % Sourced in County: TBD %
- % Sourced in County: TBD % (incl. County)

The Applicant acknowledges that the transaction/bond documents may include a covenant by the Applicant to undertake and document the total amount of capital investment as set forth in this Application.

PART IV. COST/BENEFIT ANALYSIS

- A. If the Applicant presently operates in Nassau County, provide the current annual payroll. Estimate projected payroll at the Project site in First Year, Second Year and Third Year after completion of the Project: N/A

	Present	First Year	Second Year	Third Year
Full-time:	\$ _____	\$ _____	\$ _____	\$ _____
Part-time: ²	_____	_____	_____	_____

List the average salaries or provide ranges of salaries for the following categories of jobs (on a full-time equivalency basis) projected to be retained/created in Nassau County as a result of the proposed Project:

<u>Category of Jobs to be Retained:</u>	<u>Average Salary or Range of Salary:</u>	<u>Average Fringe Benefits or Range of Fringe Benefits</u>
Management		
Professional		
Administrative		
Production		
Supervisor		
Laborer		

² NOTE: The Agency converts part-time jobs into FTE's for evaluation and reporting purposes by dividing the number of part-time jobs by two (2).

Independent Contractor ³		
Other		

<u>Category of Jobs to be Created:</u>	<u>Average Salary or Range of Salary:</u>	<u>Average Fringe Benefits or Range of Fringe Benefits</u>
Management		
Professional		
Administrative		
Production		
Supervisor		
Laborer		
Independent Contractor ⁴		
Other		

The Agency may utilize the foregoing employment projections and the projections set forth in Schedule C, among other things, to determine the financial assistance that will be offered by the Agency to the Applicant. The Applicant acknowledges that the transaction/bond documents may include a covenant by the Applicant to retain the number of jobs, types of occupations and amount of payroll with respect to the Project set forth in this Application.

- B. (i) Will the Applicant transfer current employees from existing location(s)? If YES, describe, please describe the number of current employees to be transferred and the location from which such employees would be transferred:

YES NO

- (ii) Describe the number of estimated full time equivalent construction jobs to be created as a result of undertaking the project, to the extent any:

67

³ As used in this chart, this category includes employees of independent contractors.

⁴ As used in this chart, this category includes employees of independent contractors.

- C. What, if any, is the anticipated increase in the dollar amount of production, sales or services following completion of the Project?

\$ TBD

What percentage of the foregoing amount is subject to New York sales and use tax?

TBD %

What percentage of the Applicant's total dollar amount of production, sales or services (including production, sales or services rendered following completion of the Project) are made to customers outside the economic development region (i.e., Nassau and Suffolk Counties)?

TBD %

Describe any other municipal revenues that will result from the Project (excluding the above and any PILOT payments):

Permit fees, site plan application fees, variance application fees.

- D. What is the estimated aggregate annual amount of goods and services to be purchased by the Applicant for each year after completion of the Project and what portion will be sourced from businesses located in the County and the State (including the County):

TO BE DETERMINED

	<u>Amount</u>	<u>% Sourced in County</u>	<u>% Sourced in State</u>
Year 1	\$ _____	_____	_____
Year 2	\$ _____	_____	_____
Year 3	\$ _____	_____	_____

- E. Describe, if applicable, other benefits to the County anticipated as a result of the Project, including a projected annual estimate of additional sales tax revenue generated, directly and indirectly, as a result of undertaking the project:

To be determined.

- F. Estimated Value of Requested Financial Assistance:

Estimated Value of Sales Tax Benefit: \$231,113.43
 (i.e., gross amount of cost of goods and services that are subject to state and local sales and use taxes multiplied by 8.625%)

Estimated Value of Mortgage Tax Benefit: \$ N/A
(i.e., principal amount of mortgage loans
multiplied by [0.75%])

Estimated Property Tax Benefit:

Will the proposed Project utilize a property tax
exemption benefit other than from the Agency: No
(if so, please describe)

Term of PILOT Requested: 20-years

Existing Property Taxes on Land and Building: \$ 141,302.43

Estimated Property Taxes on completed Project: \$ unknown
(without Agency financial assistance)

NOTE: Upon receipt of this Application by the Agency,
the Agency's staff will create a PILOT schedule and estimate
the amount of PILOT Benefit/Cost utilizing anticipated
tax rates and assessed valuation, and attach such information
as Exhibit A hereto.

- G. Describe and estimate any other one-time municipal revenues (not including fees payable to the Agency) that the Project will create:

Town of Oyster Bay Planning Advisory Board – Site Plan Approval; Town of Oyster Bay

Zoning Board of Appeals – Variance application.

PART V. PROJECT SCHEDULE

- A. If applicable, has construction/reconstruction/renovation work on the Project begun? If YES, indicate the percentage of completion: **N/A (Construction has not commenced)**

1. (a) Site clearance YES ___ NO ___ ___% complete

(b) Environmental Remediation YES ___ NO ___ ___% complete

(c) Foundation YES ___ NO ___ ___% complete

- (d) Footings YES ___ NO ___ ___% complete
- (e) Steel YES ___ NO ___ ___% complete
- (f) Masonry YES ___ NO ___ ___% complete
- (g) Interior YES ___ NO ___ ___% complete
- (h) Other (describe below): YES ___ NO ___ ___% complete

2. If NO to all of the above categories, what is the proposed date of commencement of construction, reconstruction, renovation, installation or equipping of the Project?

Construction to commence Fall of 2018.

- B. Provide an estimate of time schedule to complete the Project and when the first use of the Project is expected to occur:

Construction to be completed by Spring 2019.

PART VI. ENVIRONMENTAL IMPACT

- A. What is the expected environmental impact of the Project? (Complete the attached Environmental Assessment Form (Schedule G)).

The Project does not pose the potential for a significant environmental impact. Furthermore, the Town of Oyster Bay Planning Advisory Board adopted a negative declaration on the Project via Resolution Number 4-2018.

- B. Is an environmental impact statement required by Article 8 of the N.Y. Environmental Conservation Law (i.e., the New York State Environmental Quality Review Act)?

YES ___ NO X

- C. Please be advised that the Agency may require at the sole cost and expense of the Applicant the preparation and delivery to the Agency of an environmental report in form

and scope satisfactory to the Agency, depending on the responses set forth in the Environmental Assessment Form. If an environmental report has been or is being prepared in connection with the Project, please provide a copy.

- D. The Applicant authorizes the Agency to make inquiry of the United States Environmental Protection Agency, the New York State Department of Environmental Conservation or any other appropriate federal, state or local governmental agency or authority as to whether the Project site or any property adjacent to or within the immediate vicinity of the Project site is or has been identified as a site at which hazardous substances are being or have been used, stored, treated, generated, transported, processed, handled, produced, released or disposed of. The Applicant will be required to secure the written consent of the owner of the Project site to such inquiries (if the Applicant is not the owner), upon request of the Agency.

THE UNDERSIGNED HEREBY CERTIFIES, under penalties of perjury, that the answers and information provided above and in any schedule, exhibit or statement attached hereto are true, accurate and complete, to the best of the knowledge of the undersigned.

Name of Applicant: 400 WJS LLC

Signature: 
Name: Arthur D. Sanders
Title: Manager
Date: Sept. 11, 2018

Sworn to before me this 11th
day of September, 2018



Notary Public

JULIA LESHAJ
NOTARY PUBLIC OF CONNECTICUT
My Commission Expires 11/30/2020

CERTIFICATIONS AND ACKNOWLEDGMENTS OF THE APPLICANT

FIRST:

The Applicant hereby certifies that, if financial assistance is provided by the Agency for the proposed project, no funds of the Agency (i) shall be used in connection with the Project for the purpose of preventing the establishment of an industrial or manufacturing plant or for the purpose of advertising or promotional materials which depict elected or appointed government officials in either print or electronic media, (ii) be given to any group or organization which is attempting to prevent the establishment of an industrial or manufacturing plant within the State.

SECOND:

The Applicant hereby certifies that no member, manager, principal, officer or director of the Applicant or any affiliate thereof has any blood, marital or business relationship with any member of the Agency (or any member of the family of any member of the Agency).

THIRD:

The Applicant hereby certifies that neither the Applicant nor any of its affiliates, nor any of their respective partners, members, shareholders or other equity owners (other than equity owners of publicly-traded companies), nor any of their respective employees, officers, directors, or representatives (i) is a person or entity with whom United States persons or entities are restricted from doing business under regulations of the Office of Foreign Asset Control (OFAC) of the Department of the Treasury, including those named on OFAC's Specially Designated and Blocked Persons List, or under any statute, executive order or other governmental action, or (ii) has engaged in any dealings or transactions or is otherwise associated with such persons or entities.

FOURTH:

The Applicant hereby acknowledges that the Agency shall obtain and hereby authorizes the Agency to obtain credit reports and other financial background information and perform other due diligence on the Applicant and/or any other entity or individual related thereto, as the Agency may deem necessary to provide the requested financial assistance.

FIFTH:

The Applicant hereby certifies that each owner, occupant or operator that would receive financial assistance with respect to the proposed Project is in substantial compliance with applicable federal, state and local tax, worker protection and environmental laws, rules and regulations.

SIXTH:

The Applicant hereby acknowledges that the submission to the Agency of any knowingly false or knowingly misleading information may lead to the immediate termination of any financial assistance and the recapture from the Applicant of an amount equal to all or any part of any tax exemption claimed by reason of the Agency's involvement in the Project.

SEVENTH:

The Applicant hereby certifies that, as of the date of this Application, the Applicant is in substantial compliance with all provisions of Article 18-A of the General Municipal Law, including, but not limited to, the provisions of Section 859-a and Section 862(1) thereof.

EIGHTH:

(i) Does the Project propose the creation of housing?

YES ___ NO X

If YES, how many units? _____

If YES, the Applicant hereby certifies that:

(a) the Applicant has adopted a Fair Housing/Equal Housing Opportunity Policy substantially in the form of Exhibit B to this Application;

(b) the proposed Project complies with applicable fair housing laws and that eligibility criteria for housing in any part of the Project will not include any residency requirements or preferences, including durational ones, age restrictions (unless for senior housing permitted by law), or other discriminatory criteria;

(c) the Applicant (1) has posted its Fair Housing/Equal Housing Opportunity Policy publicly; and (2) will display fair housing law posters for consumers in its rental or sales office(s), in a form substantially similar to the model fair housing posters attached to this Application as Exhibit C (the Agency will provide applicants with fair housing law posters for display upon request by an applicant); and

(d) key employees of the Applicant in charge of marketing and rental of the Project have completed (or will complete within one year of closing) four (4) hours of fair housing training provided by Long Island Housing Services ("LIHS") at a reasonably acceptable time and locations and at no additional cost to the Applicant. In the event LIHS declines to provide or make available reasonably acceptable no-cost fair housing training, the provisions of this Certification VIII(i)(d) shall cease to be of any force and effect.

(ii) If YES to (i) above, does the Project propose the creation of "affordable" or "workforce" housing ("Affordable Housing")?

YES ___ NO ___

If YES, the Applicant hereby certifies that the Applicant (1) has adopted a non-discriminatory affirmative marketing plan that meets the criteria set forth in Exhibit D to this Application; and (2) will submit such marketing plan to the Agency in writing prior to closing.

If YES, answer the following questions:

(a) What portion of the Project would consist of Affordable Housing (e.g., number of units)?

(b) What are the eligibility requirements for the Affordable Housing?

(c) Cite the specific source of such eligibility requirements (e.g., federal, state or local law).

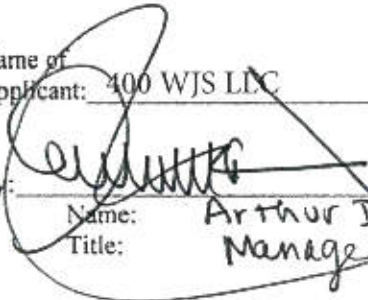
Name of Applicant: 400 WJS LLC
By: 
Name: Arthur D. Sanders
Title: Manager

**CERTIFICATION AND AGREEMENT
WITH RESPECT TO FEES AND COSTS**

Capitalized terms used but not otherwise defined in this Certification and Agreement shall have the meanings assigned to such terms in the Application.

The undersigned, being duly sworn, deposes and says, under penalties of perjury, as follows: that I am the chief executive officer or other representative authorized to bind the Applicant named in the attached application for financial assistance ("Application") and that I hold the office specified below my signature at the end of this Certification and Agreement, that I am authorized and empowered to deliver this Certification and Agreement and the Application for and on behalf of the Applicant, that I am familiar with the contents of said Application (including all schedules, exhibits and attachments thereto), and that said contents are true, accurate and complete to the best of my knowledge and belief.

The grounds of my belief relative to all matters in the Application that are not based upon my own personal knowledge are based upon investigations I have made or have caused to be made concerning the subject matter of this Application, as well as upon information acquired in the course of my duties and from the books and records of the Applicant.

As an authorized representative of the Applicant, I acknowledge and agree on behalf of the Applicant that the Applicant hereby releases the Nassau County Industrial Development Agency, its members, officers, servants, attorneys, agents and employees (collectively, the "Agency") from, agrees that the Agency shall not be liable for and agrees to indemnify, defend (with counsel selected by the Agency) and hold the Agency harmless from and against any and all liability, damages, causes of actions, losses, costs or expenses incurred by the Agency in connection with: (A) examination and processing of, and action pursuant to or upon, the Application, regardless of whether or not the Application or the financial assistance requested therein are favorably acted upon by the Agency, (B) the acquisition, construction, reconstruction, renovation, installation and/or equipping of the Project by the Agency, and (C) any further action taken by the Agency with respect to the Project; including, without limiting the generality of the foregoing, (i) all fees and expenses of the Agency's general counsel, bond counsel, economic development consultant, real property tax valuation consultant and other experts and consultants (if deemed necessary or advisable by the Agency), and (ii) all other expenses incurred by the Agency in defending any suits, actions or proceedings that may arise as a result of any of the foregoing. If, for any reason whatsoever, the Applicant fails to conclude or consummate necessary negotiations or fails within a reasonable or specified period of time to take reasonable, proper or requested action or withdraws, abandons, cancels, or neglects the Application or if the Applicant is unable to find buyers willing to purchase the total bond issue required or is unable to secure other third party financing or otherwise fails to conclude the Project, then upon presentation of an invoice by the Agency, its agents, attorneys or assigns, the Applicant shall pay to the Agency, its agents, attorneys or assigns, as the case may be, all fees and expenses reflected in any such invoice.

As an authorized representative of the Applicant, I acknowledge and agree on behalf of the Applicant that each of the Agency's general counsel, bond counsel, economic development consultant, real property tax valuation consultant and other experts and consultants is an intended third-party beneficiary of this Certification and Agreement, and that each of them may (but shall not be obligated to) enforce the provisions of the immediately preceding paragraph, whether by lawsuit or otherwise, to collect the fees and expenses of such party or person incurred by the Agency (whether or not first paid by the Agency) with respect to the Application.

Upon successful closing of the required bond issue or other form of financing or Agency assistance, the Applicant shall pay to the Agency an administrative fee set by the Agency (which amount is payable at closing) in accordance with the following schedule:

- (A) Taxable Bond Issues Six-tenths (6/10) of one percent (1%) for the first twenty million dollars (\$20,000,000) of total project costs and, if applicable, two-tenths (2/10) of one percent (1%) for any additional amounts in excess of twenty million dollars (\$20,000,000) of total project costs.
- (B) Tax-Exempt Bond Issues – Six-tenths (6/10) of one percent (1%) of total project costs.
- (C) Straight-Lease Transactions Six-tenths (6/10) of one percent (1%) for the first twenty million dollars (\$20,000,000) of total project costs and, if applicable, two-tenths (2/10) of one percent (1%) for any additional amounts in excess of twenty million dollars (\$20,000,000) of total project costs
- (D) General Counsel Fee – One-tenth (1/10) of one percent (1%) of total project costs, with a minimum fee of \$2,000.
- (E) All Initial Transactions - Two Thousand Five Hundred Dollars (\$2,500) closing compliance fee payable at closing and One Thousand Dollars (\$1,000) per year (or part thereof) administrative fee, payable in advance, at the closing for the first year (or part thereof) and on January 1st of each year for the term of the financing. The annual service fee is subject to periodic review and may be adjusted from time to time in the discretion of the Agency.
- (F) Refundings – The Agency fee shall be determined on a case-by-case basis.
- (F) Assumptions – The Agency fee shall be determined on a case-by-case basis.
- (G) Modifications – The Agency fee shall be determined on a case-by-case basis.

The Agency's bond counsel fees and expenses are payable at closing and are based on the work performed in connection with the Project.

The Agency's bond counsel's fees, general counsel fee and the administrative fees may be considered as a cost of the Project and included as part of any resultant financing, subject to compliance with applicable law.

Upon the termination of the financing of the Project, Applicant agrees to pay all costs in connection with any conveyance by the Agency to the Applicant of the Agency's interest in the Project and the termination of all related Project documents, including the fees and expenses of the Agency's general counsel, bond counsel, and all applicable recording, filing or other related fees, taxes and charges.

I further acknowledge and agree on behalf of the Applicant that, in the event the Agency shall have used all of its available tax-exempt bond financing allocation from the State of New York, if applicable, and shall accordingly be unable to obtain an additional allocation for the benefit of the Applicant, the Agency shall have no liability or responsibility as a result of the inability of the Agency to issue and deliver tax-exempt bonds for the benefit of the Applicant.

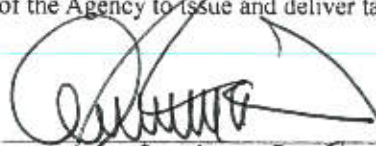
Name: Arthur D. Sanders
Title: Manager

Subscribed and affirmed to me this 11th
day of September, 2018



Notary Public

JULIA LESHAJ
NOTARY PUBLIC OF CONNECTICUT
My Commission Expires 11/30/2020

TABLE OF SCHEDULES:

Schedule	Title	Complete as Indicated Below
A.	Tax-Exempt Bond Manufacturing Questionnaire	If Applicant checked "YES" in Part I, Question H of Application, if applicable[[
B.	New York State Financial and Employment Requirements for Industrial Development Agencies	All applicants
C.	Guidelines for Access to Employment Opportunities	All applicants
D.	Anti-Raiding Questionnaire	If Applicant checked "YES" in Part I, Question O.2. of Application
E.	Retail Questionnaire	If Applicant checked "YES" in Part II, Question Q of Application
F.	Applicant's Financial Attachments, consisting of:	All applicants
	1. Applicant's financial statements for the last two fiscal years (unless included in Applicant's annual reports).	
	2. Applicant's annual reports (or Form 10-K's) for the two most recent fiscal years.	
	3. Applicant's quarterly reports (Form 10-Q's) and current reports (Form 8-K's) since the most recent Annual Report, if any.	
	4. In addition, attach the financial information described above in items F1, F2, and F3 of any anticipated Guarantor of the proposed transaction, if different than the Applicant, including the personal financial statement of any anticipated Guarantor that is a natural person.	
G.	Environmental Assessment Form	All applicants
H.	Form NYS-45-MN	All applicants
I.	Other Attachments	As required

TAX-EXEMPT BOND MANUFACTURING QUESTIONNAIRE

(To be completed by the Applicant if the Applicant checked "YES" in Part I, Question H of the Application for Financial Assistance, if applicable).

Please complete the following questions for each facility to be financed. Use additional pages as necessary.

1. Describe the production process which occurs at the facility to be financed.

2. Allocate the facility to be financed by function (expressed in square footage) (e.g., production line, employee lunchroom, offices, restrooms, storage, warehouse, loading dock, repair shop, parking, research, sales, etc.) and location in relation to production (e.g., same building, adjacent land or building, off-site, etc.). Please attach blueprints of the facility to be financed.

<u>FUNCTION</u>	<u>LOCATION</u>	<u>SQ. FOOTAGE</u>
_____	_____	_____
_____	_____	_____
_____	_____	_____

TOTAL

3. Of the space allocated to offices above, identify by function (e.g., executive offices, payroll, production, etc.) and location in relation to production (e.g., same building, adjacent land or building, off-site, etc.).

<u>FUNCTION</u>	<u>LOCATION</u>	<u>SQ. FOOTAGE</u>
_____	_____	_____
_____	_____	_____
_____	_____	_____

TOTAL

4. Of the space allocated to storage or warehousing above, identify the square footage and location of the areas devoted to storage of the following:

SQ. FOOTAGE

LOCATION

Raw Materials used
for production of
manufactured goods

Finished product storage

Component parts of
goods manufactured at
the facility

Purchased component
parts

Other (specify)

TOTAL

5. List raw materials used at the facility to be financed in the processing of the finished product(s).

6. List finished product(s) which are produced at the facility to be financed.

The UNDERSIGNED HEREBY CERTIFIES that the answers and information provided above and in any statement attached hereto are true and correct.

Name of
Applicant:

Signature:

Name:

Title:

Date:

**NEW YORK STATE FINANCIAL AND EMPLOYMENT REPORTING
REQUIREMENTS FOR INDUSTRIAL DEVELOPMENT AGENCIES**

- A. Pursuant to applicable law, the Agency requires the completion of an Initial Employment Plan (see Schedule C) and a year-end employment plan status report, both of which shall be filed by the Nassau County Industrial Development Agency (the "Agency") with the New York State Department of Economic Development. The Project documents will require the Applicant to provide such report to the Agency on or before February 11 of the succeeding year, together with such employment verification information as the Agency may require.

Except as otherwise provided by collective bargaining agreements, the Applicant agrees to list any new employment opportunities with the New York Department of Labor Community Services Division and the administrative entity of the service delivery area created by the Federal Job Training Partnership Act (P.L. 97-300), or any successor statute thereto (the "JTPA Entities"). In addition, except as otherwise provided by collective bargaining agreements, the Applicant, where practicable, will first consider persons eligible to participate in JTPA programs who shall be referred by the JTPA Entities for such new employment opportunities.

- B. The Applicant will be required to file annually a statement with the New York State Department of Taxation and Finance and the Agency of the value of all sales or use tax exemptions claimed in connection with the Project by reason of the involvement of the Agency.
- C. The following information must be provided for all bonds issued, outstanding or retired during the year:

Name, address and owner of the project; total amount of tax exemptions granted (broken out by state and local sales tax, property taxes, and mortgage recording tax); payments in lieu of taxes made; total real estate taxes on the Project prior to exemption; number of jobs created and retained, and other economic benefits realized.

Date of issue; interest rate at end of year; bonds outstanding at beginning of year; bonds issued during year; principal payments made during year; bonds outstanding at end of year; federal tax status; and maturity date(s).

Failure to provide any of the aforesaid information will be constitute a DEFAULT under the Project documents to be entered into by the Agency and the Applicant in connection with the proposed Project.

Please sign below to indicate that the Applicant has read and understood the above and agrees to provide the described information on a timely basis.

Name of
Applicant:

400 WJS LLC

Signature:

Name:

Arthur D. Sanders

Title:

Manager

Date:

9/11/18

GUIDELINES FOR ACCESS TO EMPLOYMENT OPPORTUNITIES

INITIAL EMPLOYMENT PLAN

Prior to the expenditure of bond proceeds or the granting of other financial assistance, the Applicant shall complete the following initial employment plan:

Applicant Name: 400 WJS LLC

Address: 301 North Broadway, Jericho, NY 11753

Type of Business: Real estate holding company

Contact Person: Arthur Sanders Tel. No.: _____

Please complete the following table describing the projected full-time equivalent employment plan for the proposed Project following receipt of financial assistance: **To be determined**

<u>Current and Planned Occupations</u>	<u>Present Jobs Per Occupation</u>	<u>Estimated Number of Full Time Equivalent Jobs After Completion of the Project:⁵</u>			<u>Estimate of Number of Residents of the LMA⁶ that would fill such jobs by the third year</u>
		<u>1 year</u>	<u>2 years</u>	<u>3 years</u>	
<u>Management</u>	_____	_____	_____	_____	_____
<u>Professional</u>	_____	_____	_____	_____	_____
<u>Administrative</u>	_____	_____	_____	_____	_____
<u>Production</u>	_____	_____	_____	_____	_____
<u>Supervisor</u>	_____	_____	_____	_____	_____
<u>Laborer</u>	_____	_____	_____	_____	_____
<u>Independent Contractor</u>	_____	_____	_____	_____	_____
<u>Other (describe)</u>	_____	_____	_____	_____	_____

⁵ NOTE: Convert part-time jobs into FTE's for evaluation and reporting purposes by dividing the number of part-time jobs by two (2).

⁶ The "LMA" means the Local Market Area, which is defined by the Agency as Nassau and Suffolk Counties. The Labor Market Area is the same as the Long Island Economic Development Region, as established pursuant to Section 230 of the New York State Economic Development Law.

Please indicate the number of temporary construction jobs anticipated to be created in connection with the acquisition, construction and/or renovation of the Project: 67

Please indicate the estimated hiring dates for the new jobs shown above and any special recruitment or training that will be required:

Fall 2018

Are the Applicant's employees currently covered by a collective bargaining agreement?

YES

NO X

IF YES, Union Name and Local: _____

Please note that the Agency may utilize the foregoing employment projections, among other things, to determine the financial assistance that will be offered by the Agency to the Applicant. The Applicant acknowledges that the transaction/bond documents may include a covenant by the Applicant to retain the above number of jobs, types of occupations and amount of payroll with respect to the proposed project.

Attached hereto as Schedule H is a true, correct and complete copy of the Applicant's most recent Quarterly Combined Withholding, Wage Reporting, and Unemployment Insurance Return (Form NYS-45-MN). Upon request of the Agency, the Applicant shall provide such other or additional information or documentation as the Agency may require with respect to the Applicant's current employment levels in the State of New York.

The UNDERSIGNED HEREBY CERTIFIES that the answers and information provided above and in any statement attached hereto are true, correct and complete.

Name of Applicant:

400 WJS LLC

Signature:

Name:

Arthur D. Sanders

Title:

Manager

Date:

9/11/18

ANTI-RAIDING QUESTIONNAIRE

(To be completed by Applicant if Applicant checked "YES" in Part I, Question O of the Application for Financial Assistance)

- A. Will the completion of the Project result in the removal of a plant or facility of the Applicant, or of a proposed user, occupant or tenant of the Project, or a relocation of any employee of the Applicant or of a proposed user, occupant or tenant of the Project, from an area in New York State (but outside of Nassau County) to an area within Nassau County?

YES ____

NO ____

If the answer to Question A is YES, please provide the following information:

Address of the to-be-removed plant or facility or the plants or facilities from which employees are relocated: _____

Names of all current users, occupants or tenants of the to-be-removed plant or facility: _____

- B. Will the completion of the Project result in the abandonment of one or more plants or facilities of the Applicant, or of a proposed user, occupant or tenant of the Project, located in an area of the State of New York other than in Nassau County?

YES ____

NO ____

If the answer to Question B is YES, please provide the following information:

Addresses of the to-be-abandoned plants or facilities: _____

Names of all current occupants of the to-be-abandoned plants or facilities: _____

C. Has the Applicant contacted the local industrial development agency at which its current plants or facilities in New York State are located with respect to the Applicant's intention to move or abandon such plants or facilities?

YES _____ NO _____

If the answer to Question C is YES, please provide details in a separate attachment.

IF THE ANSWER TO EITHER QUESTION A OR B IS "YES", ANSWER QUESTIONS D AND E.

D. Is the Project reasonably necessary to preserve the competitive position of the Applicant, or of a proposed user, occupant or tenant of the Project, in its industry?

YES _____ NO _____

E. Is the Project reasonably necessary to discourage the Applicant, or a proposed user, occupant or tenant of the Project, from removing such plant or facility to a location outside of the State of New York?

YES _____ NO _____

IF THE ANSWER TO EITHER QUESTION D OR E IS "YES", PLEASE PROVIDE DETAILS IN A SEPARATE ATTACHMENT.

Accordingly, the Applicant certifies that the provisions of Section 862(1) of the General Municipal Law will not be violated if financial assistance is provided by the Agency for the proposed Project.

NOTE: If the proposed Project involves the removal or abandonment of a plant or facility of the Applicant, or a proposed user, occupant or tenant of the Project, within the State of New York, notification will be made by the Agency to the chief executive officer(s) of the municipality or municipalities in which such plant or facility was located.

THE UNDERSIGNED HEREBY CERTIFIES that the answers and information provided above and in any statement attached hereto are true, correct and complete.

Name of Applicant: _____
Signature: _____
Name: _____
Title: _____
Date: _____

RETAIL QUESTIONNAIRE

(To be completed by Applicant if Applicant checked either "YES" in Part II, Question Q of the Application for Financial Assistance)

- A. Will any portion of the Project (including that portion of the cost to be financed from equity or sources other than Agency financing) consist of facilities or property that are or will be primarily used in making retail sales to customers who personally visit the Project?

YES ____

NO ____

For purposes of Question A, the term "retail sales" means (i) sales by a registered vendor under Article 28 of Tax Law of the State of New York (the "Tax Law") primarily engaged in the retail sale of tangible personal property (as defined in Section 1101(b)(4)(i) of the Tax Law), or (ii) sales of a service to customers who personally visit the Project.

- B. If the answer to Question A is YES, what percentage of the cost of the Project (including that portion of the cost to be financed from equity or sources other than Agency financing) will be expended on such facilities or property primarily used in making retail sales of goods or services to customers who personally visit the Project?

_____ %

- C. If the answer to Question A is YES, and the amount entered for Question B is greater than 33.33%, indicate whether any of the following apply to the Project:

1. Is the Project likely to attract a significant number of visitors from outside the economic development region (i.e., Nassau and Suffolk Counties) in which the Project is or will be located?

YES ____

NO ____

2. Is the predominant purpose of the Project to make available goods or services which would not, but for the Project, be reasonably accessible to the residents of the city, town or village within which the Project will be located, because of a lack of reasonably accessible retail trade facilities offering such goods or services?

YES ____

NO ____

3. Will the Project be located in one of the following: (a) an area designated as an empire zone pursuant to Article 18-B of the General Municipal Law; or (b) a census tract or block numbering area (or census tract or block numbering area contiguous thereto) which, according to the most recent census data, has (i) a poverty rate of at least 20% for the year in which the data relates, or at least 20% of the households receiving public assistance, and (ii) an unemployment rate of at least 1.25 times the statewide unemployment rate for the year to which the data relates?

YES ____

NO ____

If the answer to any of the subdivisions 1 through 3 of Question C is YES, attach details.

- D. If the answer to any of the subdivisions 2 through 3 of Question C is YES, will the Project preserve permanent, private sector jobs or increase the overall number of permanent, private sector jobs in the State of New York? If YES, attach details.

YES _____

NO _____

- E. State percentage of the Applicant's annual gross revenues comprised of each of the following:

Retail Sales: _____%

Services: _____%

- F. State percentage of Project premises utilized for same:

Retail Sales: _____%

Services: _____%

The UNDERSIGNED HEREBY CERTIFIES that the answers and information provided above and in any statement attached hereto are true, correct and complete.

Name of
Applicant:

Signature:

Name:

Title:

Date:

APPLICANT'S FINANCIAL ATTACHMENTS

ENVIRONMENTAL ASSESSMENT FORM

**Full Environmental Assessment Form
Part 1 - Project and Setting**

Instructions for Completing Part 1

Part 1 is to be completed by the applicant or project sponsor. Responses become part of the application for approval or funding, are subject to public review, and may be subject to further verification.

Complete Part 1 based on information currently available. If additional research or investigation would be needed to fully respond to any item, please answer as thoroughly as possible based on current information; indicate whether missing information does not exist, or is not reasonably available to the sponsor, and, when possible, generally describe work or studies which would be necessary to update or fully develop that information.

Applicants/sponsors must complete all items in Sections A & B. In Sections C, D & E, most items contain an initial question that must be answered either "Yes" or "No". If the answer to the initial question is "Yes", complete the sub-questions that follow. If the answer to the initial question is "No", proceed to the next question. Section F allows the project sponsor to identify and attach any additional information. Section G requires the name and signature of the project sponsor to verify that the information contained in Part 1 is accurate and complete.

A. Project and Sponsor Information.

Name of Action or Project: Application of 400 WJS LLC		
Project Location (describe, and attach a general location map): Kuhl Avenue and West John Street, Hicksville, Town of Oyster Bay, Nassau County (NCTMP Section 11 - Block 499 - Lots 90 & 102) (see attached Site Location Map)		
Brief Description of Proposed Action (include purpose or need): The proposed action involves site plan approval to permit the demolition of an existing vacant warehouse and construction of a new warehouse located at West John Street and Kuhl Avenue, Hicksville, Town of Oyster Bay, Nassau County. The proposed project includes the demolition of an existing 8,423 square foot (SF) one-story building on the eastern portion of the subject property and the construction of a new 42,454 SF, one-story warehouse/office building on the overall 2.64+-acre site. In addition, there will be a total of 82 surface parking stalls (including 4 ADA stalls) and two enclosed loading docks.		
Name of Applicant/Sponsor: 400 WJS LLC	Telephone: See Project Contact	E-Mail: See Project Contact
Address: 301 North Broadway		
City/PO: Jencho	State: New York	Zip Code: 11753
Project Contact (if not same as sponsor, give name and title/role): 400 WJS LLC c/o Judy Simoncio, Esq., Forchell, Curto, Deegan, Schwartz, Mireo and Terrano LLP	Telephone: 516-248-1700	E-Mail: jsimoncio@forchelllaw.com
Address: 133 Earle Ovington Boulevard, Suite 1010		
City/PO: Liondale	State: New York	Zip Code: 11553
Property Owner (if not same as sponsor): See Applicant	Telephone:	E-Mail:
Address:		
City/PO:	State:	Zip Code:

B. Government Approvals

B. Government Approvals, Funding, or Sponsorship. ("Funding" includes grants, loans, tax relief, and any other forms of financial assistance.)		
Government Entity	If Yes: Identify Agency and Approval(s) Required	Application Date (Actual or projected)
a. City Council, Town Board, <input type="checkbox"/> Yes <input checked="" type="checkbox"/> No or Village Board of Trustees		
b. City, Town or Village <input checked="" type="checkbox"/> Yes <input type="checkbox"/> No Planning Board or Commission	Planning Advisory Board - Site Plan Approval	February 2016
c. City Council, Town or <input type="checkbox"/> Yes <input checked="" type="checkbox"/> No Village Zoning Board of Appeals		
d. Other local agencies <input checked="" type="checkbox"/> Yes <input type="checkbox"/> No	- Town Planning Department - site plan review - Town DPW Engineering Division - SWPPP approval - Town of Oyster Bay Highway Department - curbs/cuts*	
e. County agencies <input checked="" type="checkbox"/> Yes <input type="checkbox"/> No	- NCDPW - 235 F - sewer connection - NCDPC - 238-r	
f. Regional agencies <input type="checkbox"/> Yes <input checked="" type="checkbox"/> No		
g. State agencies <input type="checkbox"/> Yes <input checked="" type="checkbox"/> No		
h. Federal agencies <input type="checkbox"/> Yes <input checked="" type="checkbox"/> No		
i. Coastal Resources:		
i. Is the project site within a Coastal Area, or the waterfront area of a Designated Inland Waterway? <input type="checkbox"/> Yes <input checked="" type="checkbox"/> No		
If yes,		
ii. Is the project site located in a community with an approved Local Waterfront Revitalization Program? <input type="checkbox"/> Yes <input type="checkbox"/> No		
iii. Is the project site within a Coastal Erosion Hazard Area? <input type="checkbox"/> Yes <input type="checkbox"/> No		

C. Planning and Zoning

C.1. Planning and zoning actions.	
Will administrative or legislative adoption, or amendment of a plan, local law, ordinance, rule or regulation be the only approval(s) which must be granted to enable the proposed action to proceed? <input type="checkbox"/> Yes <input checked="" type="checkbox"/> No	
<ul style="list-style-type: none"> If Yes, complete sections C, F and G. If No, proceed to question C.2 and complete all remaining sections and questions in Part I. 	
C.2. Adopted land use plans.	
a. Do any municipally-adopted (city, town, village or county) comprehensive land use plan(s) include the site where the proposed action would be located? <input checked="" type="checkbox"/> Yes <input type="checkbox"/> No	
If Yes, does the comprehensive plan include specific recommendations for the site where the proposed action would be located? <input type="checkbox"/> Yes <input checked="" type="checkbox"/> No	
b. Is the site of the proposed action within any local or regional special planning district (for example: Greenway, Brownfield Opportunity Area (BOA), designated State or Federal heritage area, watershed management plan, or other?) <input checked="" type="checkbox"/> Yes <input type="checkbox"/> No	
If Yes, identify the plan(s): Northwest Hicksville Brownfield Opportunity Area (BOA) Step 1	

c. Is the proposed action located wholly or partially within an area listed in an adopted municipal open space plan, or an adopted municipal farmland protection plan? <input type="checkbox"/> Yes <input checked="" type="checkbox"/> No	
If Yes, identify the plan(s): _____	

* - Hicksville Water District - Water Connection

C.3. Zoning

a. Is the site of the proposed action located in a municipality with an adopted zoning law or ordinance? Yes No
 If Yes, what is the zoning classification(s) including any applicable overlay district?
Light Industry (LI) and Neighborhood Business (NB) zoning districts

b. Is the use permitted or allowed by a special or conditional use permit? Yes No

c. Is a zoning change requested as part of the proposed action? Yes No
 If Yes,
 i. What is the proposed new zoning for the site? _____

C.4. Existing community services.

a. In what school district is the project site located? Hicksville Union Free School District

b. What police or other public protection forces serve the project site?
Nassau County Police Precinct #2

c. Which fire protection and emergency medical services serve the project site?
Hicksville Fire Department (both for fire protection and emergency medical services)

d. What parks serve the project site?
The proposed project will not place a demand on or utilize parks, although the subject property is adjacent to Carriague Park.

D. Project Details

D.1. Proposed and Potential Development

a. What is the general nature of the proposed action (e.g., residential, industrial, commercial, recreational, if mixed, include all components)?
Industrial - warehouse/office

b. a. Total acreage of the site of the proposed action? 2.64± acres
 b. Total acreage to be physically disturbed? 2.64± acres
 c. Total acreage (project site and any contiguous properties) owned or controlled by the applicant or project sponsor? 2.64± acres

c. Is the proposed action an expansion of an existing project or use? Yes No
 i. If Yes, what is the approximate percentage of the proposed expansion and identify the units (e.g., acres, miles, housing units, square feet)? % _____ Units _____

d. Is the proposed action a subdivision, or does it include a subdivision? Yes No
 If Yes,
 i. Purpose or type of subdivision? (e.g., residential, industrial, commercial; if mixed, specify types) _____
 ii. Is a cluster/conservation layout proposed? Yes No
 iii. Number of lots proposed? _____
 iv. Minimum and maximum proposed lot sizes? Minimum _____ Maximum _____

e. Will proposed action be constructed in multiple phases? Yes No
 i. If No, anticipated period of construction: 12± months
 ii. If Yes:
 • Total number of phases anticipated _____
 • Anticipated commencement date of phase 1 (including demolition) _____ month _____ year
 • Anticipated completion date of final phase _____ month _____ year
 • Generally describe connections or relationships among phases, including any contingencies where progress of one phase may determine timing or duration of future phases: _____

f. Does the project include new residential uses? <input type="checkbox"/> Yes <input checked="" type="checkbox"/> No If Yes, show numbers of units proposed.			
	<u>One Family</u>	<u>Two Family</u>	<u>Three Family</u>
<u>Multiple Family (four or more)</u>			
Initial Phase	_____	_____	_____
At completion of all phases	_____	_____	_____

g. Does the proposed action include new non-residential construction (including expansions)? <input checked="" type="checkbox"/> Yes <input type="checkbox"/> No If Yes,	
i. Total number of structures _____ ii. Dimensions (in feet) of largest proposed structure: _____ 4± height; _____ 142± width; and _____ 314± length iii. Approximate extent of building space to be heated or cooled: _____ 42,454± square feet	

h. Does the proposed action include construction or other activities that will result in the impoundment of any liquids, such as creation of a water supply, reservoir, pond, lake, waste lagoon or other storage? <input type="checkbox"/> Yes <input checked="" type="checkbox"/> No If Yes,	
i. Purpose of the impoundment: _____ ii. If a water impoundment, the principal source of the water: <input type="checkbox"/> Ground water <input type="checkbox"/> Surface water streams <input type="checkbox"/> Other specify: _____ iii. If other than water, identify the type of impounded/contained liquids and their source: _____ iv. Approximate size of the proposed impoundment. Volume _____ million gallons; surface area _____ acres v. Dimensions of the proposed dam or impounding structure: _____ height; _____ length vi. Construction method/materials for the proposed dam or impounding structure (e.g., earth fill, rock, wood, concrete): _____	

D.2. Project Operations

a. Does the proposed action include any excavation, mining, or dredging, during construction, operations, or both? (Not including general site preparation, grading or installation of utilities or foundations where all excavated materials will remain onsite) <input type="checkbox"/> Yes <input checked="" type="checkbox"/> No If Yes:	
i. What is the purpose of the excavation or dredging? _____ ii. How much material (including rock, earth, sediments, etc.) is proposed to be removed from the site? • Volume (specify tons or cubic yards) _____ • Over what duration of time? _____ iii. Describe nature and characteristics of materials to be excavated or dredged, and plans to use, manage or dispose of them: _____ _____ _____	
iv. Will there be onsite dewatering or processing of excavated materials? <input type="checkbox"/> Yes <input type="checkbox"/> No If yes, describe: _____ _____	
v. What is the total area to be dredged or excavated? _____ acres vi. What is the maximum area to be worked at any one time? _____ acres vii. What would be the maximum depth of excavation or dredging? _____ feet viii. Will the excavation require blasting? <input type="checkbox"/> Yes <input type="checkbox"/> No ix. Summarize site reclamation goals and plan: _____ _____ _____	

b. Would the proposed action cause or result in alteration of, increase or decrease in size of, or encroachment into any existing wetland, waterbody, shoreline, beach or adjacent area? <input type="checkbox"/> Yes <input checked="" type="checkbox"/> No If Yes:	
i. Identify the wetland or waterbody which would be affected (by name, water index number, wetland map number or geographic description): _____ _____	

ii. Describe how the proposed action would affect that waterbody or wetland, e.g. excavation, fill, placement of structures, or alteration of channels, banks and shorelines. Indicate extent of activities, alterations and additions in square feet or acres.

iii. Will proposed action cause or result in disturbance to bottom sediments? Yes No
 If Yes, describe: _____

iv. Will proposed action cause or result in the destruction or removal of aquatic vegetation? Yes No
 If Yes:

- acres of aquatic vegetation proposed to be removed: _____
- expected acreage of aquatic vegetation remaining after project completion: _____
- purpose of proposed removal (e.g. beach clearing, invasive species control, boat access): _____
- proposed method of plant removal: _____
- if chemical/herbicide treatment will be used, specify product(s): _____

v. Describe any proposed reclamation/mitigation following disturbance: _____

c. Will the proposed action use, or create a new demand for water? Yes No
 If Yes:

i. Total anticipated water usage/demand per day: _____ 1,669 gal/day

ii. Will the proposed action obtain water from an existing public water supply? Yes No
 If Yes:

- Name of district or service area: Hicksville Water District
- Does the existing public water supply have capacity to serve the proposal? Yes No
- Is the project site in the existing district? Yes No
- Is expansion of the district needed? Yes No
- Do existing lines serve the project site? Lot 90, Lot 102 is currently vacant Yes No

iii. Will line extension within an existing district be necessary to supply the project? Yes No
 If Yes:

- Describe extensions or capacity expansions proposed to serve this project: _____
- Source(s) of supply for the district: _____

iv. Is a new water supply district or service area proposed to be formed to serve the project site? Yes No
 If Yes:

- Applicant/sponsor for new district: _____
- Date application submitted or anticipated: _____
- Proposed source(s) of supply for new district: _____

v. If a public water supply will not be used, describe plans to provide water supply for the project: _____

vi. If water supply will be from wells (public or private), maximum pumping capacity _____ gallons/minute.

d. Will the proposed action generate liquid wastes? Yes No
 If Yes:

i. Total anticipated liquid waste generation per day: _____ 1,669 gal/day

ii. Nature of liquid wastes to be generated (e.g. sanitary wastewater, industrial; if combination, describe all components and approximate volumes or proportions of each): sanitary wastewater

iii. Will the proposed action use any existing public wastewater treatment facilities? Yes No
 If Yes:

- Name of wastewater treatment plant to be used: Cedar Creek Water Pollution Control Plant
- Name of district: Nassau County Sewage Disposal District #3
- Does the existing wastewater treatment plant have capacity to serve the project? Yes No
- Is the project site in the existing district? Yes No
- Is expansion of the district needed? Yes No

*Existing warehouse, when operational generated sewage flow and had a water demand. Figures are based on NCDPW Minimum Design Sewage Flow Rates for Sewered Areas (0.04gpd/sf for warehouse space and 0.06gpd/sf for office space). The water calculation does not include irrigation.

Page 5 of 13

<ul style="list-style-type: none"> Do existing sewer lines serve the project site? Lot 90, Lot 102 is currently vacant <input checked="" type="checkbox"/> Yes <input type="checkbox"/> No Will line extension within an existing district be necessary to serve the project? <input type="checkbox"/> Yes <input checked="" type="checkbox"/> No <p>If Yes:</p> <ul style="list-style-type: none"> Describe extensions or capacity expansions proposed to serve this project _____
<p>iv. Will a new wastewater (sewage) treatment district be formed to serve the project site? <input type="checkbox"/> Yes <input checked="" type="checkbox"/> No</p> <p>If Yes:</p> <ul style="list-style-type: none"> Applicant/sponsor for new district _____ Date application submitted or anticipated _____ What is the receiving water for the wastewater discharge? _____ <p>v. If public facilities will not be used, describe plans to provide wastewater treatment for the project, including specifying proposed receiving water (name and classification if surface discharge, or describe subsurface disposal plans).</p> <p>_____</p> <p>vi. Describe any plans or designs to capture, recycle or reuse liquid waste: _____</p> <p>_____</p>
<p>e. Will the proposed action disturb more than one acre and create stormwater runoff, either from new point sources (i.e. ditches, pipes, swales, curbs, gutters or other concentrated flows of stormwater) or non-point source (i.e. sheet flow) during construction or post construction? <input checked="" type="checkbox"/> Yes <input type="checkbox"/> No</p> <p>If Yes:</p> <p>i. How much impervious surface will the project create in relation to total size of project parcel?</p> <p>_____ Square feet or <u>2.66±</u> acres (impervious surface)</p> <p>_____ Square feet or <u>2.66±</u> acres (parcel size)</p> <p>ii. Describe types of new point sources. Drywells _____</p> <p>iii. Where will the stormwater runoff be directed (i.e. on-site stormwater management facility/structures, adjacent properties, ground/water, on-site surface water or off-site surface waters)?</p> <p>on-site stormwater management facilities (drywells): _____</p> <ul style="list-style-type: none"> If to surface waters, identify receiving water bodies or wetlands: _____ <p>_____</p> <ul style="list-style-type: none"> Will stormwater runoff flow to adjacent properties? <input type="checkbox"/> Yes <input checked="" type="checkbox"/> No <p>iv. Does proposed plan minimize impervious surfaces, use pervious materials or collect and re-use stormwater? <input type="checkbox"/> Yes <input checked="" type="checkbox"/> No</p>
<p>f. Does the proposed action include, or will it use on-site, one or more sources of air emissions, including fuel combustion, waste incineration, or other processes or operations? <input type="checkbox"/> Yes <input checked="" type="checkbox"/> No</p> <p>If Yes, identify:</p> <p>i. Mobile sources during project operations (e.g., heavy equipment, fleet or delivery vehicles) _____</p> <p>ii. Stationary sources during construction (e.g., power generation, structural heating, batch plant, crushers) _____</p> <p>iii. Stationary sources during operations (e.g., process emissions, large boilers, electric generation) _____</p>
<p>g. Will any air emission sources named in D.2.f (above), require a NY State Air Registration, Air Facility Permit, or Federal Clean Air Act Title IV or Title V Permit? <input type="checkbox"/> Yes <input checked="" type="checkbox"/> No</p> <p>If Yes:</p> <p>i. Is the project site located in an Air quality non-attainment area? (Area routinely or periodically fails to meet ambient air quality standards for all or some parts of the year) <input type="checkbox"/> Yes <input type="checkbox"/> No</p> <p>ii. In addition to emissions as calculated in the application, the project will generate:</p> <ul style="list-style-type: none"> _____ Tons/year (short tons) of Carbon Dioxide (CO₂) _____ Tons/year (short tons) of Nitrous Oxide (N₂O) _____ Tons/year (short tons) of Perfluorocarbons (PFC's) _____ Tons/year (short tons) of Sulfur Hexafluoride (SF₆) _____ Tons/year (short tons) of Carbon Dioxide equivalent of Hydrofluorocarbons (HFC's) _____ Tons/year (short tons) of Hazardous Air Pollutants (HAP's)

i. Will the proposed action generate or emit methane (including, but not limited to, sewage treatment plants, landfills, composting facilities)? Yes No
 If Yes:
 i. Estimate methane generation in tons/year (metric): _____
 ii. Describe any methane capture, control or elimination measures included in project design (e.g., combustion to generate heat or electricity, flaring): _____

i. Will the proposed action result in the release of air pollutants from open-air operations or processes, such as quarry or landfill operations? Yes No
 If Yes: Describe operations and nature of emissions (e.g., diesel exhaust, rock particulates/dust): _____

j. Will the proposed action result in a substantial increase in traffic above present levels or generate substantial new demand for transportation facilities or services? Yes No
 If Yes:
 i. When is the peak traffic expected (Check all that apply): Morning Evening Weekend
 Randomly between hours of _____ to _____
 ii. For commercial activities only, projected number of semi-trailer truck trips/day: _____
 iii. Parking spaces: Existing _____ Proposed _____ Net increase/decrease _____
 iv. Does the proposed action include any shared use parking? Yes No
 v. If the proposed action includes any modification of existing roads, creation of new roads or change in existing access, describe: _____

vi. Are public/private transportation service(s) or facilities available within 1/2 mile of the proposed site? Yes No
 vii. Will the proposed action include access to public transportation or accommodations for use of hybrid, electric or other alternative fueled vehicles? Yes No
 viii. Will the proposed action include plans for pedestrian or bicycle accommodations for connections to existing pedestrian or bicycle routes? Yes No

k. Will the proposed action (for commercial or industrial projects only) generate new or additional demand for energy? Yes No
 If Yes:
 i. Estimate annual electricity demand during operation of the proposed action: TBD based on future tenant
 ii. Anticipated sources/suppliers of electricity for the project (e.g., on-site combustion, on-site renewable, via grid/local utility, or other) via existing grid connection (PSEG Long Island) _____
 iii. Will the proposed action require a new, or an upgrade to, an existing substation? Yes No

l. Hours of operation - Answer all items which apply.

i. During Construction:		ii. During Operations: **	
• Monday - Friday:	<u>7:00 - 10:00</u>	• Monday - Friday:	<u>TBD based on future tenant</u>
• Saturday:	<u>7:00 - 10:00*</u>	• Saturday:	<u>TBD based on future tenant</u>
• Sunday:	<u>N/A</u>	• Sunday:	<u>TBD based on future tenant</u>
• Holidays:	<u>N/A</u>	• Holidays:	<u>TBD based on future tenant</u>

*Represents typical construction hours per Chapter 155, Noise, of the Oyster Bay Town Code

**In compliance with Chapter 156, Noise, of the Oyster Bay Town Code.

<p>m. Will the proposed action produce noise that will exceed existing ambient noise levels during construction, operation, or both? <input checked="" type="checkbox"/> Yes <input type="checkbox"/> No</p> <p>If yes:</p> <p>i. Provide details including sources, time of day and duration: <u>Ambient noise levels may be temporarily increased during demolition and construction activities. However, the Applicant will comply with applicable noise regulations per Chapter 156, Noise, of the Oyster Bay Town Code.</u></p> <p>ii. Will proposed action remove existing natural barriers that could act as a noise barrier or screen? <input type="checkbox"/> Yes <input checked="" type="checkbox"/> No Describe: _____</p>
<p>n. Will the proposed action have outdoor lighting? <input checked="" type="checkbox"/> Yes <input type="checkbox"/> No</p> <p>If yes:</p> <p>i. Describe source(s), location(s), height of fixture(s), direction/aim, and proximity to nearest occupied structures: <u>Pole-mounted lights with a height of 24 feet on south and west sides of the site and 14 feet on east side of the site. In addition, wallpack lights will be attached to the building at a height of 10 feet. All lights will be shielded with no spillover to residential properties. See Lighting Plan - Sheet 5 of 8 of site plan package.</u></p> <p>ii. Will proposed action remove existing natural barriers that could act as a light barrier or screen? <input type="checkbox"/> Yes <input checked="" type="checkbox"/> No Describe: _____</p>
<p>o. Does the proposed action have the potential to produce odors for more than one hour per day? <input type="checkbox"/> Yes <input checked="" type="checkbox"/> No If Yes, describe possible sources, potential frequency and duration of odor emissions, and proximity to nearest occupied structures. _____</p>
<p>p. Will the proposed action include any bulk storage of petroleum (combined capacity of over 1,100 gallons) or chemical products (85 gallons in above ground storage or any amount in underground storage)? <input type="checkbox"/> Yes <input checked="" type="checkbox"/> No</p> <p>If Yes:</p> <p>i. Product(s) to be stored _____</p> <p>ii. Volume(s) _____ per unit time _____ (e.g., month, year)</p> <p>iii. Generally describe proposed storage facilities: _____</p>
<p>q. Will the proposed action (commercial, industrial and recreational projects only) use pesticides (i.e., herbicides, insecticides) during construction or operation? <input type="checkbox"/> Yes <input checked="" type="checkbox"/> No</p> <p>If Yes:</p> <p>i. Describe proposed treatment(s): _____</p>
<p>r. Will the proposed action use Integrated Pest Management Practices? <input type="checkbox"/> Yes <input type="checkbox"/> No</p>
<p>s. Will the proposed action (commercial or industrial projects only) involve or require the management or disposal of solid waste (excluding hazardous materials)? <input checked="" type="checkbox"/> Yes <input type="checkbox"/> No</p> <p>If Yes:</p> <p>i. Describe any solid waste(s) to be generated during construction or operation of the facility:</p> <ul style="list-style-type: none"> Construction: <u>See Below</u> (tons per _____ (unit of time) ** Operation: <u>0.425±</u> tons per _____ day (unit of time) *** <p>ii. Describe any proposals for on-site minimization, recycling or reuse of materials to avoid disposal as solid waste:</p> <ul style="list-style-type: none"> Construction: <u>Concrete and similar materials will be transported off-site to be crushed and recycled.</u> Operation: <u>Future tenants will adhere to Town required recycling requirements.</u> <p>iii. Proposed disposal methods/facilities for solid waste generated on-site:</p> <ul style="list-style-type: none"> Construction: <u>Construction and demolition debris will be transported off-site by a licensed hauler to a licensed C&D facility.</u> Operation: <u>Solid waste will be transported off-site by licensed carrier (e.g. Winter Bros.) to the Town facility at Sweet Hollow Road in Bethpage.</u>

*To be determined at the time of building permit.

**Total of approximately 1,000 cubic yards of C&D material generated by site demolition.

***Estimate for general warehouse, based on "Environmental Engineering", 5th Edition, Salvato et al. (2003).

5. Does the proposed action include construction or modification of a solid waste management facility? Yes No

If Yes:

i. Type of management or handling of waste proposed for the site (e.g., recycling or transfer station, composting, landfill, or other disposal activities): _____

ii. Anticipated rate of disposal/processing:

- _____ Tons/month, if transfer or other non-combustion/thermal treatment, or
- _____ Tons/hour, if combustion or thermal treatment

iii. If landfill, anticipated site life: _____ years

6. Will proposed action at the site involve the commercial generation, treatment, storage, or disposal of hazardous waste? Yes No *

If Yes:

i. Name(s) of all hazardous wastes or constituents to be generated, handled or managed at facility: _____

ii. Generally describe processes or activities involving hazardous wastes or constituents: _____

iii. Specify amount to be handled or generated _____ tons/month

iv. Describe any proposals for on-site minimization, recycling or reuse of hazardous constituents: _____

v. Will any hazardous wastes be disposed at an existing offsite hazardous waste facility? Yes No

If Yes: provide name and location of facility: _____

If No: describe proposed management of any hazardous wastes which will not be sent to a hazardous waste facility: _____

E. Site and Setting of Proposed Action

E.1. Land uses on and surrounding the project site

a. Existing land uses.

i. Check all uses that occur on, adjoining and near the project site.

Urban Industrial Commercial Residential (suburban) Rural (non-farm)

Forest Agriculture Aquatic Other (specify): Recreation (College Park and Golf Course), Transportation (Long West Railroad)

ii. If mix of uses, generally describe:

The site contains a vacant warehouse and vacant land within an area containing a mix of land uses, including a municipal recharge basin, industrial, commercial, recreational, single family residential, and transportation uses.

b. Land uses and covertypes on the project site

Land use or Covertype	Current Acreage	Acreage After Project Completion	Change (Acres +/-)
• Roads, buildings, and other paved or impervious surfaces	0.51±	2.49±	+1.97±
• Forested	0	0	0
• Meadows, grasslands or brushlands (non-agricultural, including abandoned agricultural)	2.13± **	0	-2.13±
• Agricultural (includes active orchards, field, greenhouse etc.)	0	0	0
• Surface water features (lakes, ponds, streams, rivers, etc.)	0	0	0
• Wetlands (freshwater or tidal)	0	0	0
• Non-vegetated (bare rock, earth or fill)	0	0	0
• Other (Design/Landscaping)	0	0.16±	+0.16±

*To be determined at the time of application for building permit, based on specific tenants; **Recharge basin parcel

c. Is the project site presently used by members of the community for public recreation? Yes No
 i. If Yes, explain: _____

d. Are there any facilities serving children, the elderly, people with disabilities (e.g., schools, hospitals, licensed day care centers, or group homes) within 1500 feet of the project site? Yes No
 If Yes,
 i. Identify Facilities: _____

e. Does the project site contain an existing dam? Yes No
 If Yes:
 i. Dimensions of the dam and impoundment:
 • Dam height: _____ feet
 • Dam length: _____ feet
 • Surface area: _____ acres
 • Volume impounded: _____ gallons OR acre-feet
 ii. Dam's existing hazard classification: _____
 iii. Provide date and summarize results of last inspection: _____

f. Has the project site ever been used as a municipal, commercial or industrial solid waste management facility, or does the project site adjoin property which is now, or was at one time, used as a solid waste management facility? Yes No
 If Yes:
 i. Has the facility been formally closed? Yes No
 • If yes, cite sources/documentation: _____
 ii. Describe the location of the project site relative to the boundaries of the solid waste management facility: _____

 iii. Describe any development constraints due to the prior solid waste activities: _____

g. Have hazardous wastes been generated, treated and/or disposed of at the site, or does the project site adjoin property which is now or was at one time used to commercially treat, store and/or dispose of hazardous waste? Yes No
 If Yes:
 i. Describe wastes handled and waste management activities, including approximate date when activities occurred: _____

h. Potential contamination history: Has there been a reported spill on the proposed project site, or have any remedial actions been conducted at or adjacent to the proposed site? Yes No *
 If Yes:
 i. Is any portion of the site listed on the NYSDEC Spills Incidents database or Environmental Site Remediation database? Check all that apply: Yes No
 Yes - Spills Incidents database Provide DEC ID number(s) _____
 Yes - Environmental Site Remediation database Provide DEC ID number(s) _____
 Neither database
 ii. If site has been subject of RCRA corrective activities, describe control measures: _____

 iii. Is the project within 2000 feet of any site in the NYSDEC Environmental Site Remediation database? Yes No
 If yes, provide DEC ID number(s) _____
 iv. If yes to (i), (ii) or (iii) above, describe current status of site(s): _____

*Spills adjacent to the subject property are listed in the Attachment. There were no spills noted at the project site.

v. Is the project site subject to an institutional control limiting property uses? Yes No

- If yes, DEC site ID number: _____
- Describe the type of institutional control (e.g., deed restriction or easement): _____
- Describe any use limitations: _____
- Describe any engineering controls: _____
- Will the project affect the institutional or engineering controls in place? Yes No
- Explain: _____

E.2. Natural Resources On or Near Project Site

a. What is the average depth to bedrock on the project site? _____ 900± feet below grade surface (bgs)

b. Are there bedrock outcroppings on the project site? Yes No
 If Yes, what proportion of the site is comprised of bedrock outcroppings? _____ %

c. Predominant soil type(s) present on project site:

Pg - Pos. ground-water recharge	_____	67 %
Ug - Urban land	_____	12 %
Vt - Urban land, Vineria complex	_____	20 %

d. What is the average depth to the water table on the project site? Average: _____ 95± feet bgs

e. Drainage status of project site soils: Well Drained: _____ 100 % of site
 Moderately Well Drained: _____ % of site
 Poorly Drained: _____ % of site

f. Approximate proportion of proposed action site with slopes: 0-10%: _____ 100 % of site
 10-15%: _____ % of site
 15% or greater: _____ % of site

g. Are there any unique geologic features on the project site? Yes No
 If Yes, describe: _____

h. Surface water features:

i. Does any portion of the project site contain wetlands or other waterbodies (including streams, rivers, ponds or lakes)? Yes No

ii. Do any wetlands or other waterbodies adjoin the project site? Yes No
 If Yes to either i or ii, continue. If No, skip to E.2.i.

iii. Are any of the wetlands or waterbodies within or adjoining the project site regulated by any federal, state or local agency? Yes No

iv. For each identified regulated wetland and waterbody on the project site, provide the following information:

• Streams:	Name _____	Classification _____
• Lakes or Ponds:	Name _____	Classification _____
• Wetlands:	Name _____	Approximate Size _____
• Wetland No. (if regulated by DEC)	_____	

v. Are any of the above water bodies listed in the most recent compilation of NYS water quality-impaired waterbodies? Yes No
 If yes, name of impaired water body/bodies and basis for listing as impaired: _____

i. Is the project site in a designated Floodway? Yes No

j. Is the project site in the 100 year Floodplain? Yes No

k. Is the project site in the 500 year Floodplain? Yes No

l. Is the project site located over, or immediately adjoining, a primary, principal or site source aquifer? Yes No
 If Yes:

i. Name of aquifer: Nassau-Suffolk Site Source Aquifer

<p>m. Identify the predominant wildlife species that occupy or use the project site: _____ <small>Typical suburban species (songbirds, squirrels, etc.)</small> _____</p>	
<p>n. Does the project site contain a designated significant natural community? <input type="checkbox"/> Yes <input checked="" type="checkbox"/> No</p> <p>If Yes:</p> <p>i. Describe the habitat/community (composition, function, and basis for designation): _____</p> <p>ii. Source(s) of description or evaluation: _____</p> <p>iii. Extent of community/habitat:</p> <ul style="list-style-type: none"> • Currently: _____ acres • Following completion of project as proposed: _____ acres • Gain or loss (indicate + or -): _____ acres 	
<p>o. Does project site contain any species of plant or animal that is listed by the federal government or NYS as endangered or threatened, or does it contain any areas identified as habitat for an endangered or threatened species? <input type="checkbox"/> Yes <input checked="" type="checkbox"/> No</p>	
<p>p. Does the project site contain any species of plant or animal that is listed by NYS as rare, or as a species of special concern? <input type="checkbox"/> Yes <input checked="" type="checkbox"/> No</p>	
<p>q. Is the project site or adjoining area currently used for hunting, trapping, fishing or shell fishing? <input type="checkbox"/> Yes <input checked="" type="checkbox"/> No</p> <p>If yes, give a brief description of how the proposed activity may affect that use: _____</p>	
<p>E.3. Designated Public Resources On or Near Project Site</p>	
<p>a. Is the project site, or any portion of it, located in a designated agricultural district certified pursuant to Agriculture and Markets Law, Article 25-AA, Section 303 and 304? <input type="checkbox"/> Yes <input checked="" type="checkbox"/> No</p> <p>If Yes, provide county plus district name/number: _____</p>	
<p>b. Are agricultural lands consisting of highly productive soils present? <input type="checkbox"/> Yes <input checked="" type="checkbox"/> No</p> <p>i. If Yes: acreage(s) on project site: _____</p> <p>ii. Source(s) of soil rating(s): _____</p>	
<p>c. Does the project site contain all or part of, or is it substantially contiguous to, a registered National Natural Landmark? <input type="checkbox"/> Yes <input checked="" type="checkbox"/> No</p> <p>If Yes:</p> <p>i. Nature of the natural landmark: <input type="checkbox"/> Biological Community <input type="checkbox"/> Geological Feature</p> <p>ii. Provide brief description of landmark, including values behind designation and approximate size/extent: _____</p>	
<p>d. Is the project site located in or does it adjoin a state listed Critical Environmental Area? <input type="checkbox"/> Yes <input checked="" type="checkbox"/> No</p> <p>If Yes:</p> <p>i. CEA name: _____</p> <p>ii. Basis for designation: _____</p> <p>iii. Designating agency and date: _____</p>	

e. Does the project site contain, or is it substantially contiguous to, a building, archaeological site, or district which is listed on, or has been nominated by the NYS Board of Historic Preservation for inclusion on, the State or National Register of Historic Places? Yes No

If Yes:

i. Nature of historic/archaeological resource: Archaeological Site Historic Building or District

ii. Name: _____

iii. Brief description of attributes on which listing is based: _____

f. Is the project site, or any portion of it, located in or adjacent to an area designated as sensitive for archaeological sites on the NY State Historic Preservation Office (SHPO) archaeological site inventory? Yes No

g. Have additional archaeological or historic site(s) or resources been identified on the project site? Yes No

If Yes:

i. Describe possible resource(s): _____

ii. Basis for identification: _____

h. Is the project site within five miles of any officially designated and publicly accessible federal, state, or local scenic or aesthetic resource? Yes No

If Yes:

i. Identify resource: Northern State Parkway, Wantagh State Parkway, and Southern State Parkway

ii. Nature of, or basis for, designation (e.g., established highway overlook, state or local park, state historic trail or scenic byway, etc.): Scenic Byways

iii. Distance between project and resource: 0.57, 0.70, 4.67 (see above) miles.

i. Is the project site located within a designated river corridor under the Wild, Scenic and Recreational Rivers Program 6 NYCRR 666? Yes No

If Yes:

i. Identify the name of the river and its designation: _____

ii. Is the activity consistent with development restrictions contained in 6NYCRR Part 666? Yes No

F. Additional Information

Attach any additional information which may be needed to clarify your project.

If you have identified any adverse impacts which could be associated with your proposal, please describe those impacts plus any measures which you propose to avoid or minimize them.

G. Verification

I certify that the information provided is true to the best of my knowledge.

Applicant/Sponsor Name VHO Engineering, Surveying and Landscape Architecture, P.C. as environmental consultant to 400 WSI LLC Date October 25, 2017

Signature Gail A. Peaner Title Senior Project Manager
 Gail A. Peaner, AICP

Part 1 – Environmental Assessment Form
 400 WJS LLC
 Town of Oyster Bay, Hicksville, New York
 NCTM# Section 11 - Block 499 - Lot 90 & 102
 Attachment

Page 10. Item E.1.h, Potential Contamination History. Has there been a reported spill at the proposed project site, or have any remedial actions been conducted at or adjacent to the proposed site:

No spills were found on the proposed subject property. However, all spills listed below are within the immediate surrounding area of the subject property. All spills listed below have been closed.

Spill Number	Address	Date Spill Reported	Closed
8500486	411 WEST JOHN STREET	5/11/1985	5/15/1996
8605205	385 WEST JOHN STREET	10/5/1986	12/5/1986
8604314	385 WEST JOHN STREET	10/5/1986	10/15/1986
8604475	385 WEST JOHN STREET	10/13/1986	11/16/1987
8604793	WEST JOHN STREET	10/27/1986	9/9/1987
8807500	411 WEST JOHN STREET	12/12/1988	12/12/1988
8900590	WEST JOHN STREET, specific site unknown	4/19/1989	5/18/1989
8904008	WEST JOHN STREET, specific site unknown	7/24/1989	8/30/1989
8909135	WEST JOHN STREET	12/14/1989	12/19/1989
8911997	455 WEST JOHN STREET	3/19/1990	3/20/1990
8912105	455 WEST JOHN STREET	3/21/1990	3/27/1990
9004982	385 WEST JOHN STREET	8/5/1990	8/16/1990
9107221	WEST JOHN STREET	10/5/1991	10/7/1991
9109619	WEST JOHN STREET	12/10/1991	11/2/1994
9110529	WEST JOHN STREET	1/8/1992	2/25/1992
9110582	WEST JOHN STREET	1/9/1992	2/24/1992
9204533	WEST JOHN ST	7/20/1992	9/21/1992
9204585	WEST JOHN ST	7/21/1992	9/1/1992
9209064	WEST JOHN STREET	11/4/1992	1/13/1993
9211771	WEST JOHN STREET	1/14/1993	4/28/1994
9402659	449 WEST JOHN STREET	5/24/1994	6/2/2004
9412151	WEST JOHN STREET, specific site unknown	12/12/1994	12/16/1994
9414638	477 WEST JOHN STREET	2/7/1995	1/28/2004
9602263	WEST JOHN STREET, specific site unknown	5/16/1996	7/10/1996
9604329	385 WEST JOHN STREET	7/1/1996	7/1/1996
9708668	WEST JOHN STREET, specific site unknown	10/24/1997	11/3/2004
0000974	WEST JOHN STREET/KUHL AVE	4/24/2000	12/11/2000
105157	455 WEST JOHN STREET	8/13/2001	9/27/2001
400700	477 WEST JOHN STREET	4/21/2004	4/21/2004
750790	455 WEST JOHN STREET	8/30/2007	6/6/2011
802101	455 WEST JOHN STREET	5/23/2008	9/30/2008
910464	477 WEST JOHN STREET	12/23/2009	9/28/2010
912809	477 WEST JOHN STREET	3/10/2010	3/12/2010
1206479	449 WEST JOHN STREET	10/1/2012	12/9/2013
1703513	455 WEST JOHN STREET	7/11/2017	10/12/2017

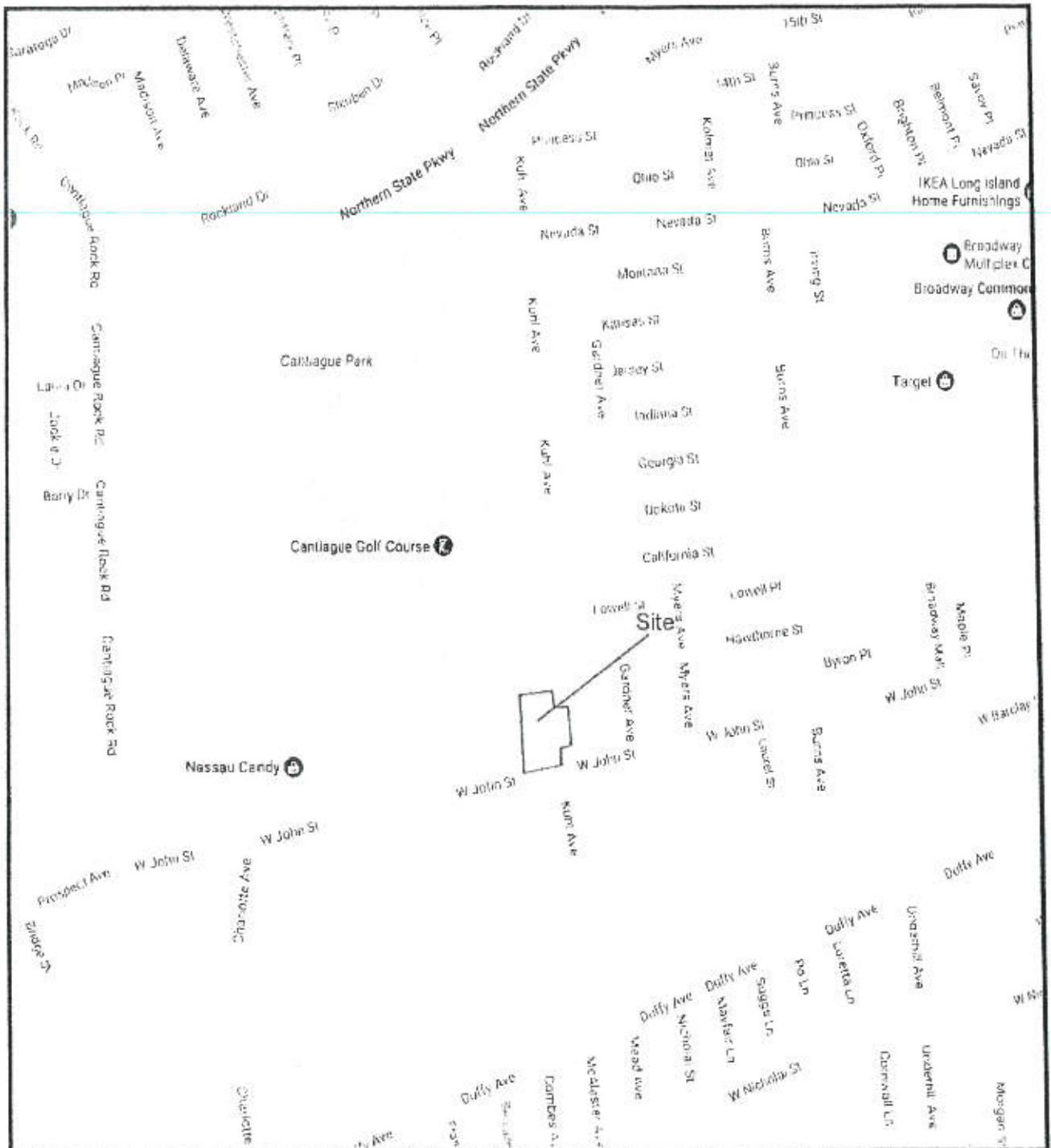

SITE LOCATION MAP

SITE NAME: 400 WJS LLC
STREET ADDRESS: Kuhl Avenue and West John Street
MUNICIPALITY, STATE, ZIP: Hicksville, NY, 11801
PROJECT NUMBER: 25935.00

SOURCE: Google Maps

 Subject Property



*Not to scale

FORM NYS-45-MN

Attach most recent quarterly filing of Form NYS-45-MN, as well as the most recent fourth quarter filing. Please remove the employee social security numbers and note which employees are part-time.

NOT APPLICABLE

OTHER ATTACHMENTS

Part III – Capital Costs of the Project

C. Have any of the above costs been paid or incurred (including contracts of sale or purchase orders) as of the date of this application?

As of the date of this application, the Applicant has paid the purchase price of \$1,625,000 for the land and vacant building, design costs, legal costs for Town of Oyster Bay Site Plan approval, and demolition costs associated with the demolition of the existing building and site clearance.

EXHIBIT A

Upon acceptance of the Application by the Agency for processing and completion of the Cost/Benefit Analysis, the Agency will attach a proposed PILOT Schedule hereto, together with an estimate of the net tax benefit/cost of the proposed PILOT Schedule.

EXHIBIT B

Fair Housing/Equal Housing Opportunity Policy to be adopted by Agency Applicants for Housing Projects

As part of our continuing effort to ensure compliance with federal, state, and local anti-discrimination laws, we would like to take this opportunity to remind you of our policies regarding equal housing opportunity. It is important for all employees to review his or her own actions in light of these requirements and for everyone to keep in mind the importance of treating all persons equally.

It is the policy and practice of this company not to engage in or assist the efforts of others to engage in housing discrimination. Consistent with that policy, we remind you that the antidiscrimination laws of the United States, New York State, and local laws are quite specific in the area of housing, and in conformance with those laws, you must not engage in any of the following conduct during the course of your work for this company:

1. Refuse to show, rent, sell, negotiate for the rental or sale of, or otherwise make unavailable or deny, housing to any person because of race, color, religion, creed, sex/gender, familial status (having or expecting a child under 18), national origin, ethnicity, disability, marital status, age, sexual orientation, military status, source of income or status as survivor of domestic violence (each a "prohibited basis");
2. Discriminate against any person in the terms, conditions or privileges of a rental or sale or in the provision of services or facilities in connection therewith because of a prohibited basis;
3. Make any verbal or written statement with respect to the rental or sale of housing that indicates any preference, limitation or discrimination concerning a prohibited basis, or any statement indicating an intention to make any such preference, limitation or discrimination;
4. Represent to any person because of a prohibited basis that any housing or unit is not available for inspection, rental or sale when such apartment is in fact so available;
5. Steer persons into or away from certain areas of a building, development or neighborhood because of a prohibited basis;
6. Refuse to provide a reasonable accommodation in rules, policies, practices or services for tenants, buyers, or applicants with disabilities; and
7. Refuse to allow a reasonable modification to individual units or common areas for tenants, buyers, or applicants with disabilities.

We are firmly committed to the goal of fair housing. You should understand that any violation of this Fair Housing/Equal Housing Opportunity Policy will lead to discipline, up to and including discharge.

EXHIBIT C

Sample Fair Housing Posters

U. S. Department of Housing and Urban Development



EQUAL HOUSING
OPPORTUNITY

**We Do Business in Accordance With the Federal Fair
Housing Law**

(The Fair Housing Amendments Act of 1988)

**It is illegal to Discriminate Against Any Person
Because of Race, Color, Religion, Sex,
Handicap, Familial Status, or National Origin**

- In the sale or rental of housing or residential lots
- In the provision of real estate brokerage services
- In advertising the sale or rental of housing
- In the appraisal of housing
- In the financing of housing
- Blockbusting is also illegal

Anyone who feels he or she has been discriminated against may file a complaint of housing discrimination:

1-800-669-9777 (Toll Free)

1-800-927-9275 (TTY)

www.hud.gov/fairhousing

U.S. Department of Housing and
Urban Development
Assistant Secretary for Fair Housing and
Equal Opportunity
Washington, D.C. 20410

Printed on recycled paper.

Form HUD-923.1 (6/2011)

HOUSING
DISCRIMINATION IS
SOMETIMES **BLATANT**,
SOMETIMES
/ ,
BUT ALWAYS UNLAWFUL.

Do you suspect you have been discriminated against because of your age, race, disability, familial status, or because you are a member of other protected classes? If you witness or experience discrimination, contact the New York State Division of Human Rights at 1-888-392-3644 or WWW.DHR.NY.GOV.

This advertisement was made possible through the U.S. Department of Housing and Urban Development.

GOVERNMENT
DIVISION OF
HUMAN
RIGHTS

NY
SPRING



EXHIBIT D
Requirements for Affirmative Marketing Plans for Housing Projects

Affirmative marketing plans submitted by the Applicant shall be required only for affordable or “workforce” units and shall contain the following information:

1. Street address, village, town, zip code, and census tract number for the Project;
2. Number of affordable units to be marketed and whether they will be available for rent or purchase;
3. The number, if any, and location of market rate units included in the Project;
4. Whether the housing will be “housing for older persons”, defined as at least 80% occupancy of units with at least one person 55 or older or 100% occupancy of persons age 62 or older;
5. A description of how units will be advertised for sale or rental prior to first occupancy, including whether Applicant will utilize its own website, commercial websites, print media outlets, social media outlets such as Facebook, a sign at the project site, mailings, leaflets/flyers, brochures, and other forms of advertising;
6. A statement that the Applicant will use fair housing logo or phrase “Equal Housing Opportunity” on all advertising described above;
7. A statement that the Applicant will distribute written information regarding the availability of affordable units at the project to a list of organizations provided to the Applicant by the Agency, which list may be updated annually;
8. Whether the Applicant will conduct the marketing and initial rent-up or sales itself or contract with a third-party;
9. A statement that an initial application period with a specific start and end date will be utilized for accepting applications for consideration for the initial rental of the units and that the period will last for at least thirty (30) days after the marketing described in this plan is commenced. In addition, a statement that following the initial application period, all the applications submitted during the initial application period will be considered through the use of a lottery and not on a first-come first-served basis, unless the number of applications received during the initial application period is less than the total number of units available for rental.
10. A statement that the Applicant will maintain records of the activities it undertakes to implement its marketing plan.